

# minimax *line*

elite range





# All “Made in SCM Italy”

*From casting iron to finished product.*

Come see our production plants and touch the quality of SCM machines;  
you will be our guest.



## minimax

the passion that deserves professional products.

minimax is the line of professional machines for woodworkers, a point of reference for over 40 years worldwide.

SCM's objective is to guarantee customers high quality technologies which meet their requirements in such a way as to make SCM the partner for any needs.

## elite

Solid, flexible and economical.

combined machines

**cu 410e**  
page 6



**fs 41e**  
page 7



**st 4e**  
page 7



# App Thundercut

## Technology at your fingertips

SCM Thundercut is the Optimizer/Sequencer App for mobile devices, that allows to optimize the panel surface and guides the operator through the cutting sequence.

**High cut speed execution, less material waste and mistake odds minimized, even for not skilled workers!**

Download it now from the AppStore and Google Play:

SCM Thundercut



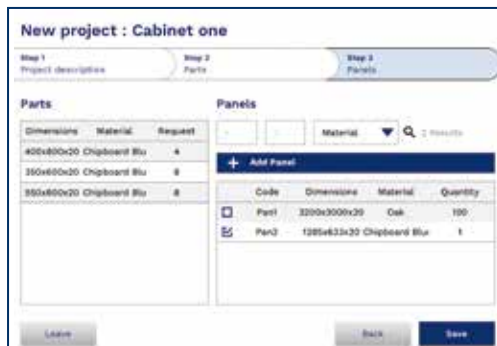
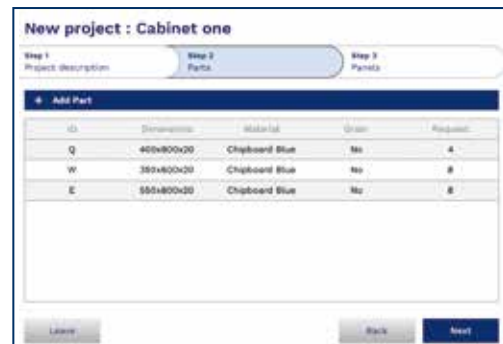
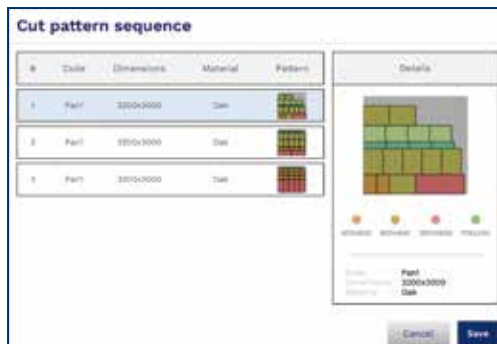

You can manage your circular saws fleet, the material warehouse and many project you are working on.

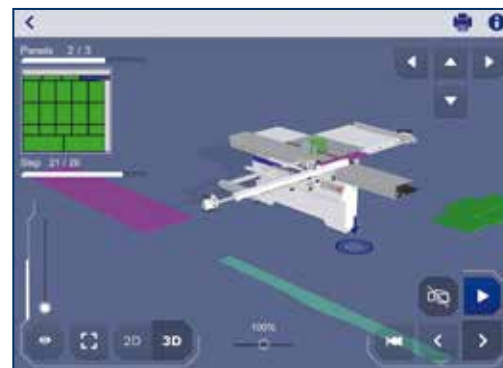

The 3D sequencer, thanks to its simple and clear design, suggest the ideal settings of the machine for every single cut to be executed.

The App is available for circular saws, circular saws with movable blade unit, saw-shaper combination machines and universal combination machines (you will find the QR code to activate the App in each new machine).



# elite

## combined machines

cu 410e universal combined machine

fs 41e surfacing-thicknessing planer

st 4e saw-spindle moulder



		cu 410e	fs 41e	st 4e
Planer useful working width	mm	410	410	-
Total length of surfacing tables	mm	2000	2000	-
Min. ÷ max. working height on thicknesser	mm	3 ÷ 240	3 ÷ 240	-
Max. saw blade diameter with <b>scoring blade installed</b>	mm	315	-	315
Squaring stroke	mm	1600 ÷ 3200	-	1600 ÷ 3200
Max. useful spindle length	mm	125	-	125
Three-phase motors starting from	kW/Hz	4 (4,8) / 50 (60)	4 (4,8) / 50 (60)	4 (4,8) / 50 (60)
<i>Find the complete technical specification at page 12</i>				

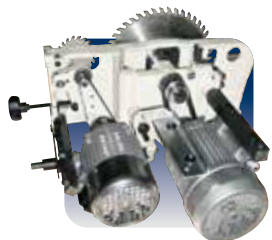

**Saw Unit**  
stability and rigidity



**Planer Cutter Block**  
perfect finishing



**Spindle Moulder**  
versatility



**Digital Readout**  
hi-tech devices



**Sliding Table**  
precise and silent



**SCM  
Thundercut**  
Optimizer/  
Sequencer App

Solid, flexible and affordable machines for woodworking shops and demanding craftsmen that want to achieve a qualitatively superior finished product.

# elite machining units



stability and rigidity

## Saw Unit.

The new **saw unit closed loop structure is made of a heavy cast iron** and is supported firmly under the table by two lateral supports in a crescent shape. These solutions give strength and rigidity, guaranteeing perfect cutting results. The saw unit can be equipped, on request, with scoring blade for perfect cutting even on veneered panels. The scoring blade is an option available in two versions: with belt transmission from the main motor and with an independent motor 0.75 HP (0.55 kW). The maximum diameter allowed for the main saw is **315 mm with scoring blade mounted**.

The lifting of the blade unit is done by a robust cast iron structure with dovetail system.



The rotation fulcrums of the saw unit have a 120 mm diameter and stand on steady crescent shaped rests that separate it from the base: a rigid reliable solution.



90° ÷ 45°

The scoring blade is adjustable from the outside without tools and allows fast and accurate positioning with no play.







precise and silent

#### Sliding Table.

Optimal support also to larger pieces, with the **sliding table 360 mm wide**. Exceptional precision and smoothness: to secure the guides it is not used glue, since the thickness could affect sliding. They are secured with a procedure of aluminum riveting.

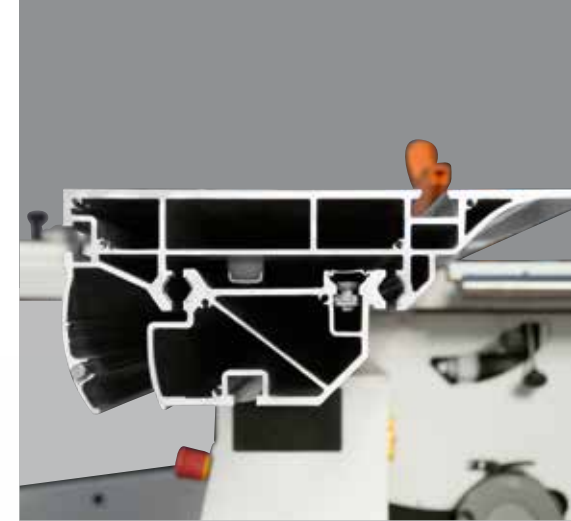

high-tech devices

#### Digital Readout.

The round cross-section sliding bar for the parallel fence (optional device for **cu 410e**) with micrometric adjustments ensures a smooth, fast and especially precise positioning of the fence. The support of the fence can also be equipped with a **digital readout**, with the sensor running on a magnetic stripe (option).



Panel loading is easy on the **large squaring frame** with an idle roller at the end. The **telescopic squaring fence with two reversible stops** can be used to square panels measuring 3200 x 3200 mm and for miter cuts at up to 45° on both sides of the frame.

# elite machining units



perfect finishing

## Planer Cutter Block.

The planer unit stands on cast iron supports and the standard version has a 87 mm diameter cutter block with 3 knives. (The optional "Tersa" cutter block is available with 4 quick tightening knives and automatic adjustment).

For an impeccable finish, the pressure of the thicknesser feed rollers can be adjusted according to the type of wood machined.

The infeed roller (A) has a **helicoidal profile** to guarantee firm and constant work piece feed, while the outfeed roller (B), in sandblasted steel, maintains the perfect post-processing finishing.



A

B



Two feed speed for the standard thicknesser (6 - 12 m/min.). In the **cu 410e** the planers open towards the circular saw-spindle moulder side: an ergonomic solution with minimum amount of space.

The **fs 41e** uses a dedicated planing fence extremely rigid and smooth, thanks to a support with central round bar.



functional and customisable

A machine even more versatile: with the practical **mortiser** (option) drilling holes or mortises are easily done.





versatility

### Spindle Moulder.

Maximum stability and rigidity in all working conditions, thanks to a large spindle moulder column made entirely of cast iron.

The 4 standard speeds are ideal for any type of machining, from moulding to routing and tenoning with the possibility to fit tools up to 275 mm of diameter. The spindle is surrounded by a cast iron "cup" **to protect the internal mechanical components** from shavings and sawdust.



high-tech devices

### Moulder Fence.

The standard spindle moulder hood (A) can house tools of maximum diameter 210 mm. Available as an option, the spindle moulder hood that uses an adjustment system of the guides through rack and it has a mechanical digital readout (B). Thanks to the **memories system**, this hood can be removed and replaced without losing the operating position. The maximum capacity of the tool used in profiling is 240 mm in diameter. It is available, on request, the tilting spindle 45° towards the inside machine.



A



B





# elite dimensions and technical data

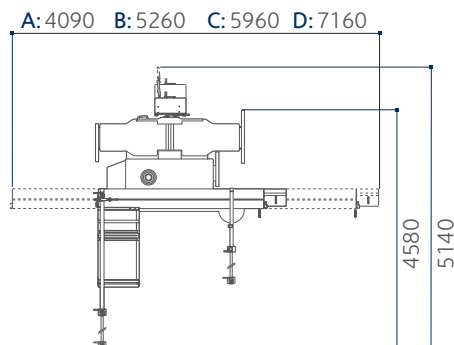

cu 410e

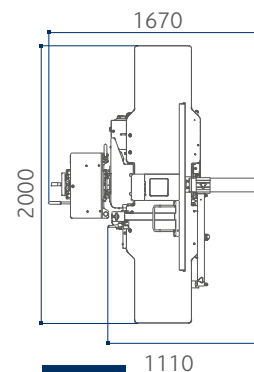

fs 41e

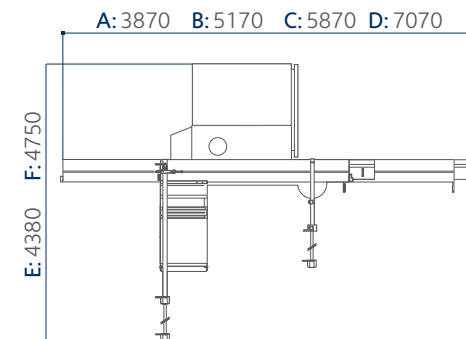

st 4e

S Standard  
O Option

		cu 410e	fs 41e	st 4e
<b>planer</b>				
Working width	mm	410	410	-
Cutter block diameter (mm)/no. of standard knives	mm/n.	87 / 3	87 / 3	-
Dimensions of standard knives	mm	410 x 30 x 3	410 x 30 x 3	-
Max. stock removal	mm	5	5	-
Surfacing tables total length	mm	2000	2000	-
Thickening table dimensions	mm	423 x 775	423 x 775	-
Feed speed on thickener	m/min	6 / 12	6 / 12	-
Min. ÷ max. working height on thickener	mm	3 ÷ 230	3 ÷ 230	-
<b>circular saw</b>				
Cast iron saw-spindle moulder worktable dimensions	mm	1250 x 430	-	1250 x 430
Saw blade tilting		90° ÷ 45°	-	90° ÷ 45°
Max. saw blade diameter <b>with scoring blade installed</b>	mm	315	-	315
Max. saw blade projection from table at 90°/45°	mm	100 / 70	-	100 / 70
Squaring stroke	mm	1600 ÷ 3200	-	1600 ÷ 3200
Cutting width on parallel fence	mm	1050	-	900 ÷ 1270
<b>spindle moulder</b>				
Max. useful spindle length	mm	125	-	125
Spindle moulder speeds (at 50 Hz)	rpm	3500 / 6000 / 8000 / 10.000	-	3500 / 6000 / 8000 / 10.000
Max. tool diameter when profiling	mm	210 ÷ 240	-	210 ÷ 240
Max. diameter of tool lowered under the table at 90°	mm	240	-	240
Max. tool diameter when tenoning	mm	275	-	275
<b>other technical features</b>				
Three-phase motors 4 kW (5,5 hp) 50 Hz - 4,8 kW (6,5 hp) 60 Hz		S	S	S
Three-phase motors 5 kW (6,6 hp) 50 Hz - 6 kW (8 hp) 60 Hz		O	O	O
Three-phase motors 7 kW (9,5 hp) 50 Hz <b>with direct start</b>		O	O	O
Single-phase motors 2,2 kW (3 hp) 50 Hz		O	O	O
Single-phase motors S1 3,6 kW (4,8 hp) 60 Hz		O	O	O
Exhaust outlets diameter	mm	120	120	120

- 
- A with wagon 1600 mm  
B with wagon 2250 mm  
C with wagon 2600 mm  
D with wagon 3200 mm  
E with 900 mm cutting width\*  
F with 1270 mm cutting width\*  
*\*at the parallel fence*

# elite main optional devices

tablet holder on the  
sliding carriage  
Compatible with tablets from 8" to 11".



angular cutting device with flip-over stops  
To rapidly perform mitre cuts without moving the squaring fence.  
Recommended for mitre cuts on small work pieces.

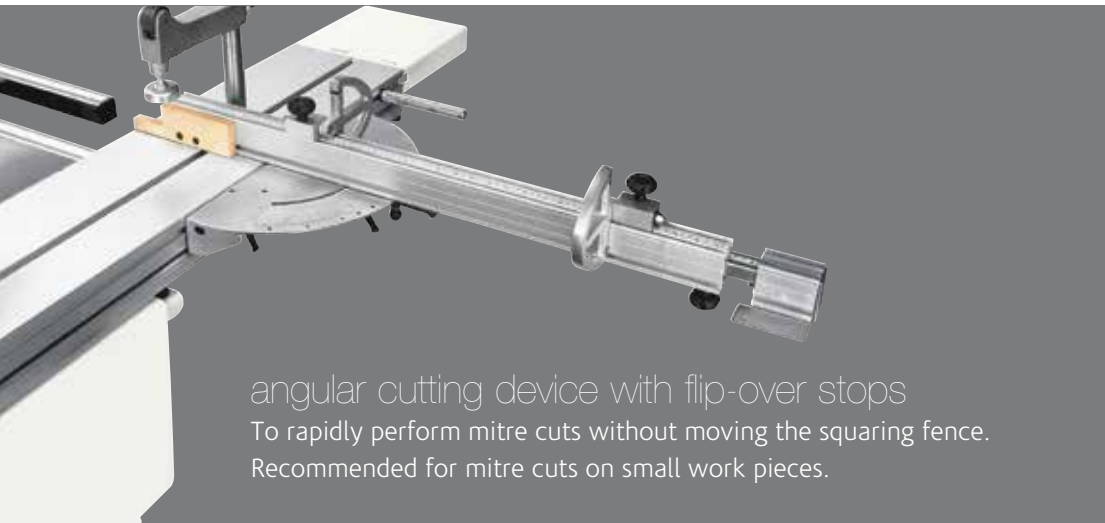

overhead blade protection  
For totally safe machining.



pre-set angular  
cutting device  
directly positioned  
on squaring frame  
To find rapidly the most  
common angles with the  
squaring fence. Useful for  
large work pieces.



digital readout for the fence  
position on the parallel fence  
It allows precise positioning with the  
magnetic strip sensor.





### "Tersa" cutter block

Automatic knives clamping by means of the centrifugal force ensures safe and precise machining. The system, without fixing screws, makes knives substitution extremely fast.



### cast iron mortiser

Drilling holes and mortises are easily carried out. Complete with exhaust hood, 120 mm diameter and 16 mm chuck.



### "Xylent" spiralknife cutter block with 3 series of knives

The 3 spiralknives give an exceptional finish. Reduced noise during machining provides a more comfortable working environment. It also improves the dust extraction due to the production of very small chips. Each cutter has 4 tips which can be rotated into the cutting position when worn. Therefore increasing the production life of the cutter block before knives require replacement.

self-centering chuck  
0-16 mm "Wescott" type  
The mortiser spindles can be rapidly substituted without the necessity of adjustment.



### maintenance case for "Xylent" spiralknife

Complete with:

- 1 cleaning/degreasing liquid bottle for the resins cleaning
- 1 set dynamometric key
- 2 bit Torx
- 10 inserts
- 5 screws
- 1 brass bristle brush to clean the spindle with mounted in inserts
- 1 steel bristle brush to clean the inserts housings



### chuck with clamp

It allows harder machining thanks to the stronger bits. The chuck includes 3 clamps 5/10/16 mm.



additional overturning  
fence for thin work pieces  
It ensures optimum operator safety  
when machining thin work pieces.



A



B

interchangeable spindle (A)  
For a very quick spindle  
substitution. Among the spare  
spindle, it is available also the  
spindle for router bits. (B)

tenoning table and  
protection hood  
For the tenoning operations on the  
spindle moulder. It consists of:  
- table  
- protection hood for tools,  
275 mm diameter  
- exhaust hood, 120 mm diameter



Dado set  
Mechanical presetting to use a  
tool (not included) in place of  
the main blade.



electric pre-setting and flip  
over support for feeder  
This solution allows a total  
exclusion of the device and prevents  
interference with other parts of  
the machine.



additional table on the sliding carriage  
For the support of large dimensioned panels.

# elite main optional devices

S Standard  
O Option

	cu 410e	fs 41e	st 4e
"SCM Thundercut" Optimizer/Sequencer App	S	-	S
Tablet holder on the sliding carriage	O	-	O
Angular cutting device with flip-over stops	O	-	O
Pre-set angular cutting device directly positioned on squaring frame	O	-	O
Digital readout for the fence position on the parallel fence	-	-	O
Additional table on the sliding carriage	O	-	O
Overhead blade protection	-	-	O
Numerical readouts for the groups positioning	O	O	O
"Tersa" cutter block	O	O	-
"Xylent" spiralknife cutter block with 3 series of knife	O	O	-
Maintenance case for "Xylent" spiralknives	O	O	-
Cast iron mortiser	O	O	-
Self-centering chuck 0-16 mm "Wescott" type	O	O	-
Chuck with clamp	O	O	-
Additional overturning fence for thin work pieces	-	O	-
Three movement adjustable spindle moulder fence	O	-	O
Tenoning table and protection hood	O	-	O
Electric pre-setting and flip over support for feeder	O	-	O
Interchangeable spindle	O	-	O
Wheels for machine movement	O	O	-
Dado set	O	-	O





**SERVICE AND MAINTENANCE**



**TRAINING SERVICE**



**SPARE PARTS**



**DIGITAL SERVICES**

**scm** | service

**WE'LL GO THE  
EXTRA MILE  
FOR YOU**

**CONTACT**

**SCM SERVICE**

Via Emilia 77 - 47921 Rimini - Italy  
tel. +39 0541 700100  
[scmservice@scmgroup.com](mailto:scmservice@scmgroup.com)  
[www.scmwood.com](http://www.scmwood.com)

**SCM SPAREPARTS**

Via Emilia, 61 - 47921 - Rimini - Italy  
tel. +39 0541 674111  
[spareparts@scmgroup.com](mailto:spareparts@scmgroup.com)  
[www.scmwood.com](http://www.scmwood.com)

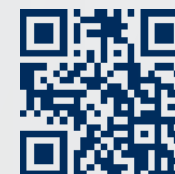

My Scm

# SCM OFFERS A FULL RANGE OF **HIGHLY SPECIALISED SERVICES** WITH A QUALITY AND RELIABILITY THAT STEM FROM 70 YEARS OF EXPERIENCE IN THE INDUSTRY.

From installation and production start-up to services and maintenance.  
From training to the supply of specific original spare parts: **we provide solutions designed around you!**



## SERVICE AND MAINTENANCE

- Remote support
- Scheduled maintenance contracts
- Warranty extension



## TRAINING SERVICE

- Courses for machine operators
- Software and programming courses
- Training in production start-up



## SPARE PARTS

- Recommended spare parts list
- E-shop
- Interactive spare-parts catalogues
- Repairs on electronic parts, glue tanks and electro-spindles



## DIGITAL SERVICES

- Maestro Connect - IoT platform to be constantly connected with your machines
- Smartech - assistance with augmented reality
- My Scm portal - opening of service ticket and single point of access to the apps and Services tools

# SOLUTIONS AND SERVICES ALWAYS CONNECTED FOR YOU



**SCM, A STRATEGIC PARTNER, BY YOUR SIDE AT EACH STAGE OF YOUR BUSINESS PROCESS**

SCM has always stood alongside companies in the woodworking sector, with **technological solutions and services which are constantly connected to maximise the machine's efficiency, improve product quality and reduce operating costs.**



**70+** years history

**3** main production sites in Italy

**300.000** square metres of production space

**20.000** machines manufactured per year

**90%** export

**20+** foreign branches

**400** agents and dealers

**500** support technicians

**500** registered patents

## SCM GROUP, THE MOST ADVANCED SKILLS AND KNOW-HOW IN THE FIELDS OF MACHINERY AND INDUSTRIAL COMPONENTS OVER THE LAST 70 YEARS

### INDUSTRIAL MACHINERY

Stand-alone machines, integrated systems and services dedicated to processing a wide range of materials.



Woodworking technology



Composite, aluminium, plastic, glass, stone, metal technology



Technologies for the profiles processing of aluminium, PVC and light alloy



Automated systems for industry

### INDUSTRIAL COMPONENTS

Technological components for the Group's machines and systems, for those of third-parties and for the mechanical industry.



Electrospindles and technological components



Electrical panels



Metalworking and mechanical machining



Iron castings



**Company of the Scm Group**

**registered office:**

via Emilia, 77  
47921 Rimini, Italia  
T. +39 0541 700111  
F. +39 0541 700232

**sales office:**

via Casale, 450  
47826 Villa Verucchio, Rimini, Italia  
T. +39 0541 674111  
F. +39 0541 674274  
[scm@scmgroup.com](mailto:scm@scmgroup.com)  
[www.scmwood.com](http://www.scmwood.com)

**Scm Industria Spa**

**Professional Workshop Machinery**

via Valdicella, 7  
47892 Gualdicciolo,  
Repubblica di San Marino  
[scm@scmgroup.com](mailto:scm@scmgroup.com)

**sales dept. Italy:**

T. +378 0549 876911  
F. +378 0549 999604

**foreign sales dept.:**

T. +39 0541 674111  
F. +39 0541 674274  
[www.scmwood.com](http://www.scmwood.com)

The motors powers in this catalogue are expressed in S6, except where otherwise specified. In this catalogue, machines are shown in CE configuration and with options. We reserve the right to modify technical specifications without prior notice, provided that such modifications do not affect safety as per CE norms.

rev.03  
09/2025

Mic Studio







**SCM GROUP SPA**

via Casale 450 - 47826 Villa Verucchio, Rimini - Italy  
tel. +39 0541 674111 - fax +39 0541 674274  
[scm@scmgroup.com](mailto:scm@scmgroup.com)  
[www.scmwood.com](http://www.scmwood.com)



00L0593163D