

minimax *line*

elite s range



All “Made in SCM Italy”

From casting iron to finished product.

Come see our production plants and touch the quality of SCM machines;
you will be our guest.



minimax

the passion that deserves professional products.

minimax is the line of professional machines for woodworkers, a point of reference for over 40 years worldwide.

SCM's objective is to guarantee customers high quality technologies which meet their requirements in such a way as to make SCM the partner for any needs.

minimax elite s

Maximum expression of professional performances and technology.

combined machines

cu 410es
page 6



st 5es
page 7



planers

fs 52es
page 8



f 52es
page 9



s 52es
page 9



fs 41es
page 10



f 41es
page 11



s 41es
page 11



spindle moulders

tw 55es
page 12



t 55es
page 13



App Thundercut

Technology at your fingertips

SCM Thundercut is the Optimizer/Sequencer App for mobile devices, that allows to optimize the panel surface and guides the operator through the cutting sequence.

High cut speed execution, less material waste and mistake odds minimized, even for not skilled workers!

Download it now from the AppStore and Google Play:

SCM Thundercut



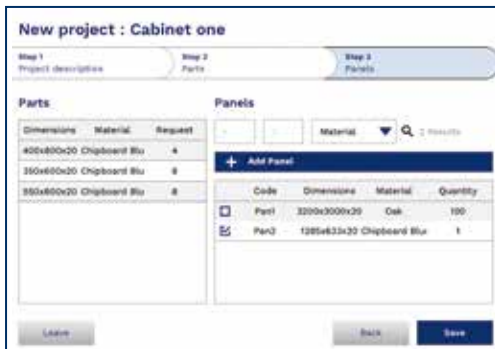
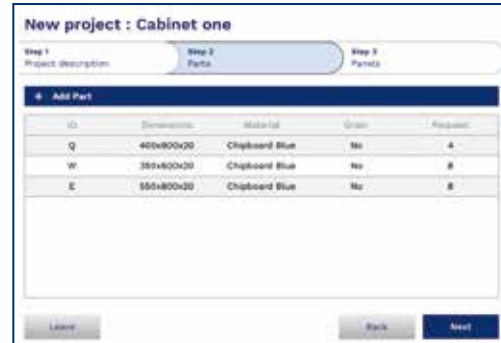
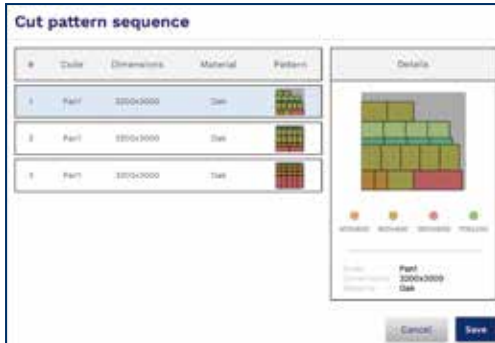

You can manage your circular saws fleet, the material warehouse and many project you are working on.



The 3D sequencer, thanks to its simple and clear design, suggest the ideal settings of the machine for every single cut to be executed.

The App is available for circular saws, circular saws with movable blade unit, saw-shaper combination machines and universal combination machines (you will find the QR code to activate the App in each new machine).

elite s

combined machines

cu 410es universal combined machine

st 5es saw-spindle moulder



		cu 410es	st 5es
Planer useful working width	mm	410	-
Total length of surfacing tables	mm	2200	-
Max. saw blade diameter with scoring blade installed	mm	350	350
Squaring stroke	mm	2250 ÷ 3200	2250 ÷ 3200
Max. spindle length	mm	125	125
Three-phase motors starting from	kW/Hz	5 (6) / 50 (60)	5 (6) / 50 (60)
<i>Find the complete technical specification at page 18</i>			



Saw Unit
unique worldwide



Squaring Fence
immediate control



Spindle Moulder
unsurpassed
moulding



Front Handwheels
ergonomic



Sliding Carriage
unrivalled cutting
finishing



**SCM
Thundercut**
Optimizer/
Sequencer App

Technology and professional performances
in the woodworking combined machines,
for an unmatched working precision.

elite s
planers
fs 52es surfacing-thicknessing planer
f 52es surfacing planer
s 52es thicknessing planer



		fs 52es	f 52es	s 52es
Planer useful working width	mm	520	520	520
Cutter block diameter (mm)/no. of standard knives	mm/n.	120 / 4	120 / 4	120 / 4
Total length of surfacing tables	mm	2250	2250	-
Min. ÷ max. working height on thicknesser	mm	3 ÷ 240	-	3 ÷ 240
Three-phase motors starting from	kW/Hz	7 (8) / 50 (60)	5 (6) / 50 (60)	7 (8) / 50 (60)
<i>Find the complete technical specification at page 18</i>				

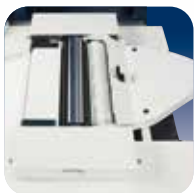

**Planer Cutter
Block**
perfect finishing



Thickening Table
stability over time



Surfacing Tables
fast set-up



Xylent
absolute silence



Planing Fence
absolute rigidity

Professional planers at an accessible price, for woodworking shops and demanding craftsmen that require high standard and no compromises.

elite s
planers
fs 41es surfacing-thicknessing planer
f 41es surfacing planer
s 41es thicknessing planer



		fs 41es	f 41es	s 41es
Planer useful working width	mm	410	410	410
Cutter block diameter (mm)/no. of standard knives	mm/n.	95 / 4	95 / 4	95 / 4
Total length of surfacing tables	mm	2200	2200	-
Min. ÷ max. working height on thicknesser	mm	3 ÷ 240	-	3 ÷ 240
Three-phase motors starting from	kW/Hz	5 (6) / 50 (60)	5 (6) / 50 (60)	5 (6) / 50 (60)
<i>Find the complete technical specification at page 18</i>				

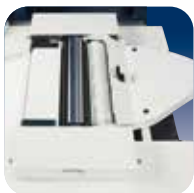

**Planer Cutter
Block**
perfect finishing



Thickening Table
stability over time



Surfacing Tables
fast set-up



Xylent
absolute silence



Planing Fence
absolute rigidity

Professional planers at an accessible price, for woodworking shops and demanding craftsmen that require high standard and no compromises.

elite s
spindle moulders
tw 55es with fixed or tilting spindle
t 55es with fixed spindle



		tw 55es	t 55es
Max. useful spindle length	mm	125	125
Max. tool diameter when profiling	mm	210 ÷ 240	210 ÷ 240
Max. tool diameter lowered under the table at 90°	mm	240	240
Max. tool diameter when tenoning	mm	320 (300 no CE)	-
Three-phase motors starting from	kW/Hz	5 (6) / 50 (60)	5 (6) / 50 (60)
<i>Find the complete technical specification at page 18</i>			



Spindle Moulder
unsurpassed
moulding

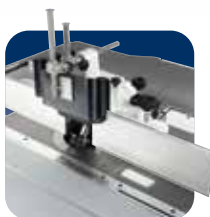

Moulder Fence
high-tech devices



Sliding Carriage
unrivalled cutting
finishing

The professional spindle moulders that allow for customization and flexibility, for woodworking shops and demanding craftsmen.

elite s machining units



unique worldwide

Saw Unit

The cast iron saw unit **with a rigid closed loop structure** can accommodate a **blade of 350 mm diameter with the scoring blade mounted (unique in the world in its category!)** ensuring perfect and easy cutting of veneer panels and thick solid wood material. The saw blade uses 100% of the motor power, thanks to the **scoring blade with an independent motor as standard.**

The lifting of the blade unit is done by a robust cast iron structure with dovetail system.



The rotation fulcrums of the saw unit have a 120 mm diameter and stand on steady crescent shaped rests that separate it from the base: a rigid reliable solution.



90° ÷ 45°

The scoring blade is adjustable from the outside without tools and allows fast and accurate positioning with no play.





high-tech devices **Controls on Carriage.**

Wide range of high-tech devices to make your *elite s* even more powerful and personalized, like the **start/stop pushbuttons for the main blade and scoring blade integrated in the sliding carriage**; very useful when machining large dimensioned work pieces that prevent an easy and safe access to the main machine control panel.



immediate control **Squaring Frame and Fence.**

Panel loading is easy on the large squaring frame with an idle roller at the end. **The telescopic squaring fence with the inclined metric scale and two reversible stops** can be used to square panels measuring 3200x3200 mm and for tilted cuts at up to 45° on both sides of the frame.

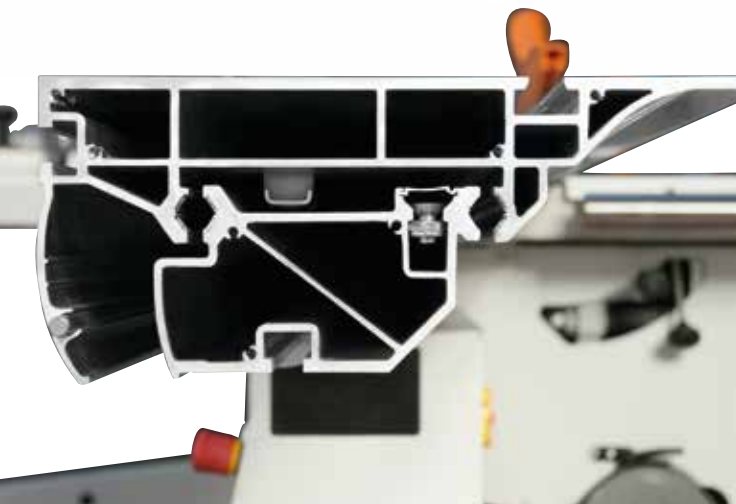

unrivalled cutting finishing **Sliding Carriage.**

Optimal support also to larger pieces, with the **sliding carriage 360 mm wide**. Exceptional precision and smoothness: to secure the guides it is not used glue, since the thickness could affect sliding. They are secured with a procedure of aluminum riveting.

elite s machining units

absolute rigidity
Planing Fence.
High rigid fence with a smooth
movement thanks to the **central**
locking on round bar.

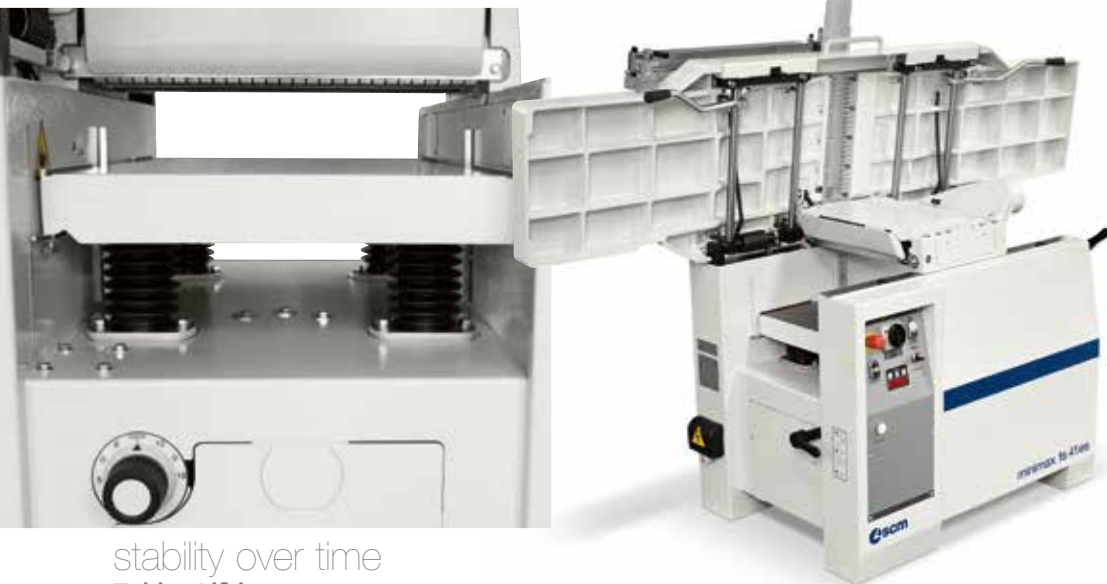

stability over time

Tables Lifting.

Comfortable and precise planing. The *elite s* range adopt ergonomic solutions like the **2200 mm surfacing tables**, in ribbed cast iron, **with simultaneous opening** towards the inside of the machine with a 90° angle. For a maximum long lasting stability the cast iron thickening table lifts on **4 spindles with trapezoidal threads dust protected.**



perfect finishing
Planer Cutter Block.

An optimal planing with minimal effort, thanks to the 95 mm diameter cutter block (120 mm in planers of 520 mm working width) and 4 knives. For an impeccable finish the pressure of the thicknesser feed rollers can be adjusted according to the type of wood machined. The roller infeed (A) has a **helicoidal profile** to guarantee firm and constant work piece feed, while the outfeed roller (B) in sandblasted steel maintains the perfect post-processing finishing.



A

B

The spindle is surrounded by a cast iron "cup" to **protect the internal mechanical components** from shavings and sawdust.

unsurpassed moulding **Spindle Moulder.**

Maximum stability and rigidity in all working conditions, thanks to a large spindle moulder column made entirely of cast iron.

The 4 standard speed are ideal for any type of machining, from moulding to routing and tenoning, with the possibility to fit tools up to 320 mm of diameter (300 mm no CE).



high-tech devices **Moulder Fence.**

The spindle moulder hood uses a system for adjusting the guides with a rack and it is fitted with a mechanical digital readout. Thanks to the **system of memories** (on *t 55es* and *tw 55es* available as option) the hood can be removed and repositioned without losing the machining position. The maximum tool diameter mounted on the spindle lowered under the table at 90° is 240 mm. On request it is available with a spindle that tilts 45° (towards the inside of the machine).

elite s

dimensions and technical data

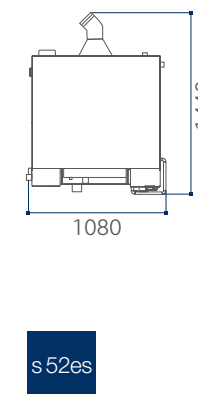
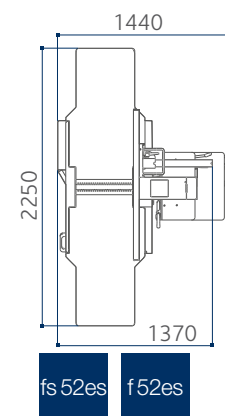
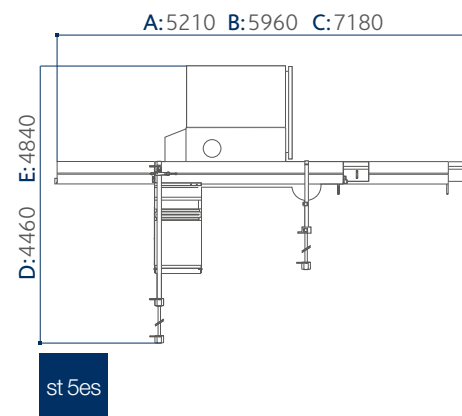
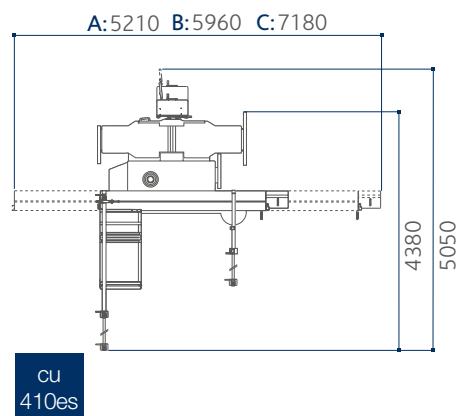

- A with 2250 mm carriage
 - B with 2600 mm carriage
 - C with 3200 mm carriage
 - D with 900 mm cutting width *
 - E with 1270 mm cutting width *
- *at the parallel fence

cu 410es		
planer		
Working width	mm	410
Cutter block diameter (mm)/no. of standard knives	mm/n.	95 / 4
Dimensions of standard knives	mm	410 x 30 x 3
Max. stock removal	mm	5
Surfacing tables total length	mm	2200
Thickening tables dimensions	mm	410 x 775
Feed speed on thickener	m/min	6 / 12
Min. ÷ max. working height on thickener	mm	3 ÷ 240
circular saw		
Cast iron saw-spindle moulder worktable dimensions	mm	1380 x 465
Saw blade tilting		90° ÷ 45°
Max. saw blade diameter with scoring blade installed	mm	350
Max. saw blade projection from table at 90°/45°	mm	118 / 84
Squaring stroke	mm	2250 ÷ 3200
Cutting width on parallel fence	mm	1000
spindle moulder		
Max. useful spindle length	mm	125
Spindle moulder speeds (at 50 Hz)	rpm	3500/6000/8000/10.000
Max. tool diameter when profiling	mm	240
Max. diameter of tool lowered under the table at 90°	mm	240
Max. tool diameter when tenoning	mm	320 (300 no CE)
other technical features		
Three-phase motors 5 kW (6,6 hp) 50 Hz - 6 kW (8 hp) 60 Hz		S
Three-phase motors 7 kW (9,5 hp) 50 Hz with automatic star-delta start		O
Three-phase motors 9 kW (12 hp) 50 Hz - 11 kW (15 hp) 60 Hz		-
with automatic star-delta start		-
Single-phase motors 2,2 kW (3 hp) 50 Hz		-
Single-phase motors S1 3,6 kW (4,8 hp) 60 Hz		O
Exhaust outlets diameter	mm	120

S Standard
O Option

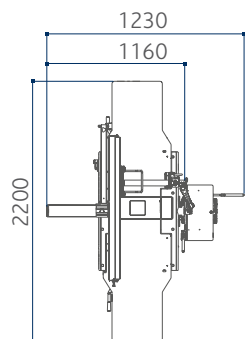

fs 41es f 41es

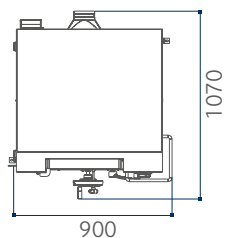

s 41es

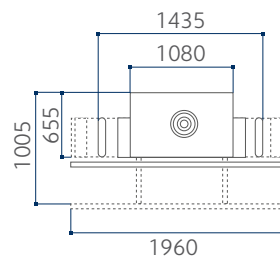

t 55es

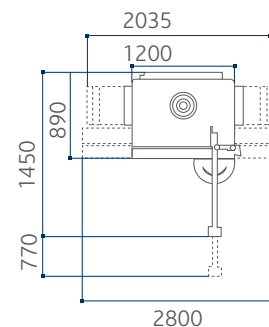

tw
55es

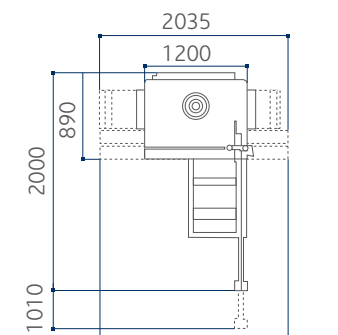

tw
55es
2800
with support frame

st 5es	fs 52es	f 52es	s 52es	fs 41es	f 41es	s 41es	tw 55es	t 55es
-	520	520	520	410	410	410	-	-
-	120 / 4	120 / 4	120 / 4	95 / 4	95 / 4	95 / 4	-	-
-	520 x 30 x 3	520 x 30 x 3	520 x 30 x 3	410 x 30 x 3	410 x 30 x 3	410 x 30 x 3	-	-
-	5	5	5	5	5	5	-	-
-	2250	2250	-	2200	2200	-	-	-
-	520 x 850	-	520 x 850	410 x 775	-	410 x 775	-	-
-	5 / 8 / 12 / 18	-	5 / 8 / 12 / 18	6 / 12	-	6 / 12	-	-
-	3 ÷ 240	-	3 ÷ 240	3 ÷ 240	-	3 ÷ 240	-	-
1380 x 465	-	-	-	-	-	-	-	-
90° ÷ 45°	-	-	-	-	-	-	-	-
350	-	-	-	-	-	-	-	-
118 / 84	-	-	-	-	-	-	-	-
2250 ÷ 3200	-	-	-	-	-	-	-	-
900 ÷ 1270	-	-	-	-	-	-	-	-
125	-	-	-	-	-	-	125	125
3500/6000/8000/10.000	-	-	-	-	-	-	3500/6000/8000/10.000	3500/6000/8000/10.000
240	-	-	-	-	-	-	210 ÷ 240	210 ÷ 240
240	-	-	-	-	-	-	240	240
320 (300 no CE)	-	-	-	-	-	-	320 (300 no CE)	-
S	-	S	-	S	S	S	S	S
O	S	O	S	O	-	O	O	O
-	O	-	O	-	-	-	-	-
-	-	-	-	-	-	-	O	O
O	O	O	O	O	O	O	O	O
120	120	120	120	120	120	120	120	120

elite s main optional devices

digital readouts
On squaring stops with
micrometric adjustment.



Compex
To rapidly obtain angular
cuttings with automatic
self-adjustment of the
stops position.



angular cutting device with flip-over stops
To rapidly perform mitre cuts without moving the squaring fence.
Recommended for mitre cuts on small work pieces.

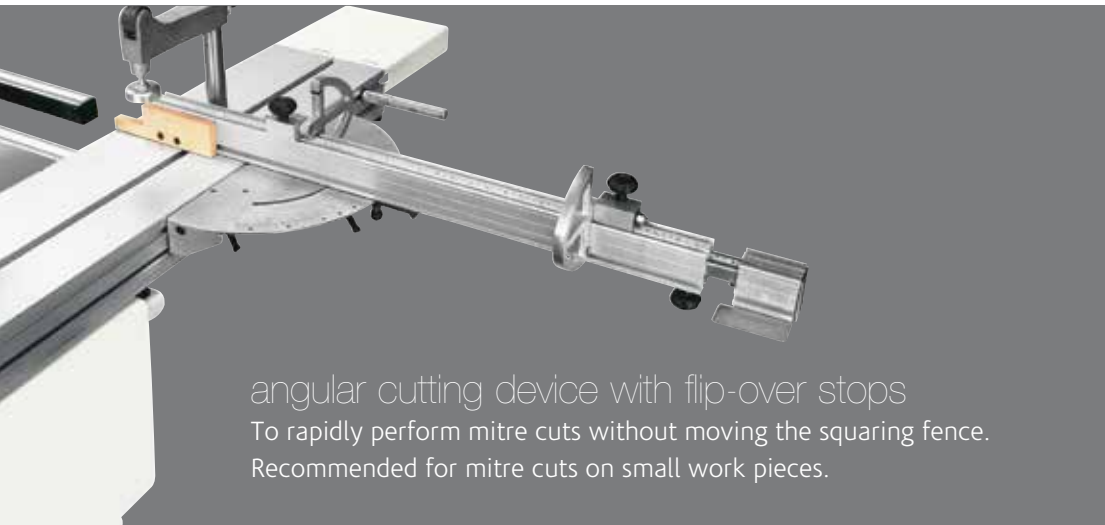

pre-set angular
cutting device
directly positioned
on squaring frame
To find rapidly the most
common angles with the
squaring fence. Useful for
large work pieces.



Expandable scoring blade
Manually expandable with variable
thickness from 2,8 to 3,6 mm.
Blade diameter: 120 mm.



additional table on the sliding carriage
For the support of large dimensioned panels.

pushbuttons integrated
in the sliding carriage
The possibility to start or stop the blades
motors from the pushbuttons located at the
ends of the carriage considerably helps when
machining large dimensioned panels.



overhead blade
protection
For totally safe
machining.



Dado set
Mechanical presetting to
use a tool (not included)
in place of the main blade.

supporto per tablet su
carro scorrevole
Compatibile con tablet da 8" a 11".



digital readout
for the fence
position on the
parallel fence
It allows precise
positioning with the
magnetic strip sensor.

elite s
main
optional
devices



additional overturning fence
for thin work pieces
It ensures optimum operator safety when
machining thin work pieces.

thickening table extension to be
used in infeed or outfeed
It can be installed on the
worktable end side.



thickening table with two removable idle rollers
It assists the feed for demanding pieces.



"Tersa" cutter block

Automatic knives clamping by means of the centrifugal force ensures safe and precise machining. The system, without fixing screws, makes knives substitution extremely fast.



cast iron mortiser

Drilling holes and mortises are easily carried out. Complete with exhaust hood, 120 mm diameter and 16 mm chuck.



"Xylent" spiralknife cutter block with 3 series of knives

The 3 spiralknives give an exceptional finish. Reduced noise during machining provides a more comfortable working environment. It also improves the dust extraction due to the production of very small chips. Each cutter has 4 tips which can be rotated into the cutting position when worn. Therefore increasing the production life of the cutter block before knives require replacement.

self-centering chuck
0-16 mm "Wescott" type
The mortiser spindles can be rapidly substituted without the necessity of adjustment.



maintenance case for "Xylent" spiralknife

Complete with:

- 1 cleaning/degreasing liquid bottle for the resins cleaning
- 1 set dynamometric key
- 2 bit Torx
- 10 inserts
- 5 screws
- 1 brass bristle brush to clean the spindle with mounted in inserts
- 1 steel bristle brush to clean the inserts housings



chuck with clamp

It allows harder machining thanks to the stronger bits. The chuck includes 3 clamps 5/10/16 mm.

elite s main optional devices

interchangeable spindle (A)

For a very quick spindle substitution. Among the spare spindle, it is available also the spindle for router bits. (B)



B



tenoning table and protection hood

For the tenoning operations on the spindle moulder. It consists of:

- table
- protection hood for tools, 320 mm diameter (300 mm USA/Canada)
- exhaust hood, 120 mm diameter



roller telescopic extensions for spindle moulder

For the machining of work pieces with large dimensions.



electric pre-setting and flip over support for feeder

This solution allows a total exclusion of the device and prevents interference with other parts of the machine.



powered handling of the operating groups with digital readouts

For the best precision and easy-to-use.



elite s

main

optional

devices

- S Standard
 O Option
 * Standard for CE and USA/Canada versions

	cu 410es	st 5es	fs 52es	f 52es	s 52es	fs 41es	f 41es	s 41es	tw 55es	t 55es
"SCM Thundercut" Optimizer/Sequencer App	S	S	-	-	-	-	-	-	-	-
Angular cutting device with flip-over stops	O	O	-	-	-	-	-	-	-	-
Pre-set angular cutting device directly positioned on squaring frame	O	O	-	-	-	-	-	-	-	-
Digital readout for the fence position on the parallel fence	-	O	-	-	-	-	-	-	-	-
Start/stop pushbuttons for the saw blade and scoring blade integrated in the sliding carriage	O	O	-	-	-	-	-	-	-	-
Additional table on the sliding carriage	O	O	-	-	-	-	-	-	-	-
Overhead blade protection	-	O*	-	-	-	-	-	-	-	-
"Tersa" cutter block	O	-	O	O	O	O	O	O	-	-
"Xylent" spiralknife cutter block with 3 series of knives	O	-	O	O	O	O	O	O	-	-
Maintenance case for "Xylent" spiralknife	O	-	O	O	O	O	O	O	-	-
Cast iron mortiser	O	-	O	O	-	O	O	-	-	-
Self-centering chuck 0-16 mm "Wescott" type	O	-	O	O	-	O	O	-	-	-
Chuck with clamp	O	-	O	O	-	O	O	-	-	-
Thicknessing table with two removable idle rollers	-	-	O	-	O	-	-	-	-	-
Additional overturning fence for thin work pieces	-	-	O	O	-	O	O	-	-	-
Tenoning table and protection hood	O	O	-	-	-	-	-	-	O	-
Electric pre-setting and flip over support for feeder	O	O	-	-	-	-	-	-	O	-
Interchangeable spindle	O	O	-	-	-	-	-	-	O	O
Roller telescopic extensions for spindle moulder	-	-	-	-	-	-	-	-	O	O
Powered handling of the operating groups with digital readouts	O	O	O	-	S	O	-	O	O	-
Complex	O	O	-	-	-	-	-	-	-	-
Dado set	-	O	-	-	-	-	-	-	-	-
Digital readouts	O	O	-	-	-	-	-	-	-	-
Ready 3 / Programmed parallel fence	-	-	-	-	-	-	-	-	-	-
Tablet holder on the sliding carriage	O	O	-	-	-	-	-	-	-	-
Thicknessing table extension to be used in infeed or outfeed	-	-	O	-	O	-	-	-	-	-



SERVICE AND MAINTENANCE



TRAINING SERVICE



SPARE PARTS



DIGITAL SERVICES

scm | service

**WE'LL GO THE
EXTRA MILE
FOR YOU**

CONTACT

SCM SERVICE

Via Emilia 77 - 47921 Rimini - Italy
tel. +39 0541 700100
scmservice@scmgroup.com
www.scmwood.com

SCM SPAREPARTS

Via Emilia, 61 - 47921 - Rimini - Italy
tel. +39 0541 674111
spareparts@scmgroup.com
www.scmwood.com

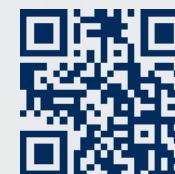

My Scm

SCM OFFERS A FULL RANGE OF **HIGHLY SPECIALISED SERVICES** WITH A QUALITY AND RELIABILITY THAT STEM FROM 70 YEARS OF EXPERIENCE IN THE INDUSTRY.

From installation and production start-up to services and maintenance.
From training to the supply of specific original spare parts: **we provide solutions designed around you!**



SERVICE AND MAINTENANCE

- Remote support
- Scheduled maintenance contracts
- Warranty extension



TRAINING SERVICE

- Courses for machine operators
- Software and programming courses
- Training in production start-up



SPARE PARTS

- Recommended spare parts list
- E-shop
- Interactive spare-parts catalogues
- Repairs on electronic parts, glue tanks and electro-spindles



DIGITAL SERVICES

- Maestro Connect - IoT platform to be constantly connected with your machines
- Smartech - assistance with augmented reality
- My Scm portal - opening of service ticket and single point of access to the apps and Services tools

SOLUTIONS AND SERVICES ALWAYS CONNECTED FOR YOU



SCM, A STRATEGIC PARTNER, BY YOUR SIDE AT EACH STAGE OF YOUR BUSINESS PROCESS

SCM has always stood alongside companies in the woodworking sector, with **technological solutions and services which are constantly connected to maximise the machine's efficiency, improve product quality and reduce operating costs.**

70+ years history

3 main production sites in Italy

300.000 square metres of production space

20.000 machines manufactured per year

90% export

20+ foreign branches

400 agents and dealers

500 support technicians

500 registered patents

SCM GROUP, THE MOST ADVANCED SKILLS AND KNOW-HOW IN THE FIELDS OF MACHINERY AND INDUSTRIAL COMPONENTS OVER THE LAST 70 YEARS

INDUSTRIAL MACHINERY

Stand-alone machines, integrated systems and services dedicated to processing a wide range of materials.



Woodworking technology



Composite, aluminium, plastic, glass, stone, metal technology



Technologies for the profiles processing of aluminium, PVC and light alloy



Automated systems for industry

INDUSTRIAL COMPONENTS

Technological components for the Group's machines and systems, for those of third-parties and for the mechanical industry.



Electrospindles and technological components



Electrical panels



Metalworking and mechanical machining



Iron castings



is more



Company of the Scm Group

registered office:

via Emilia, 77
47921 Rimini, Italia
T. +39 0541 700111
F. +39 0541 700232

sales office:

via Casale, 450
47826 Villa Verucchio, Rimini, Italia
T. +39 0541 674111
F. +39 0541 674274
scm@scmgroup.com
www.scmwood.com

Scm Industria Spa

Professional Workshop Machinery

via Valdicella, 7
47892 Gualdicciolo,
Repubblica di San Marino
scm@scmgroup.com

sales dept. Italy:

T. +378 0549 876911
F. +378 0549 999604

foreign sales dept.:

T. +39 0541 674111
F. +39 0541 674274
www.scmwood.com

The motors powers in this catalogue are expressed in S6, except where otherwise specified. In this catalogue, machines are shown in CE configuration and with options. We reserve the right to modify technical specifications without prior notice, provided that such modifications do not affect safety as per CE norms.

rev.04
09/2025

Mic Studio





SCM GROUP SPA

via Casale 450 - 47826 Villa Verucchio, Rimini - Italy
tel. +39 0541 674111 - fax +39 0541 674274
scm@scmgroup.com
www.scmwood.com



00L0592668E